

## REMOVAL

### Transmission

#### Removal

1. Disconnect the battery ground cable. For additional information, refer to Section 414-01.
2. With the vehicle in NEUTRAL, position it on a hoist. For additional information, refer to Section 100-02.
3. Remove the catalytic converter H-pipe. For additional information, refer to Section 309-00.
4. Remove the driveshaft. For additional information, refer to Section 205-01.
5. Remove the starter motor. For additional information, refer to Section 303-06.
6. Disconnect the reversing lamp switch electrical connector. Disconnect the wiring harness from the transmission.

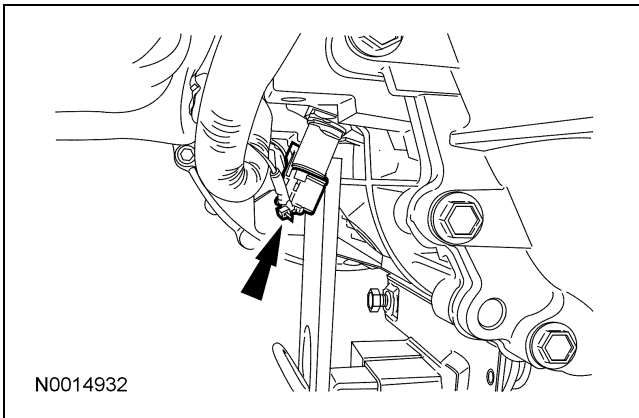

7. Disconnect the OSS sensor electrical connector. Disconnect the wiring harness from the transmission.

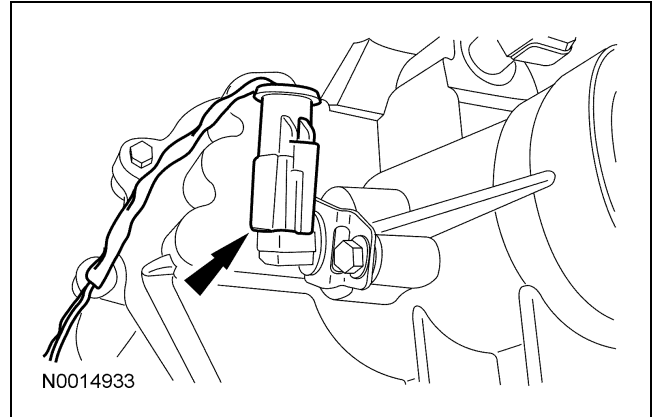

8. If transmission disassembly is necessary, drain the transmission fluid.

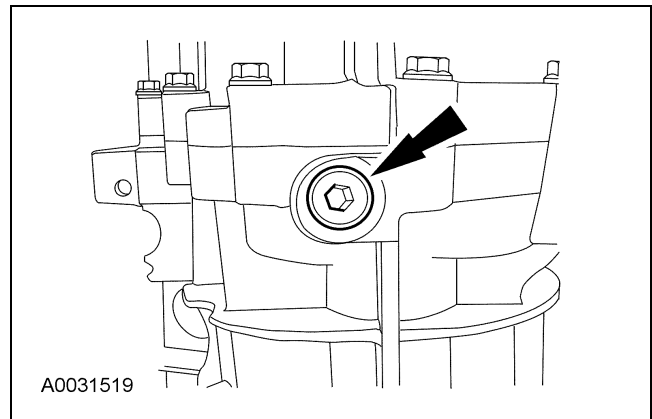

9. Position a transmission jack and support the transmission.

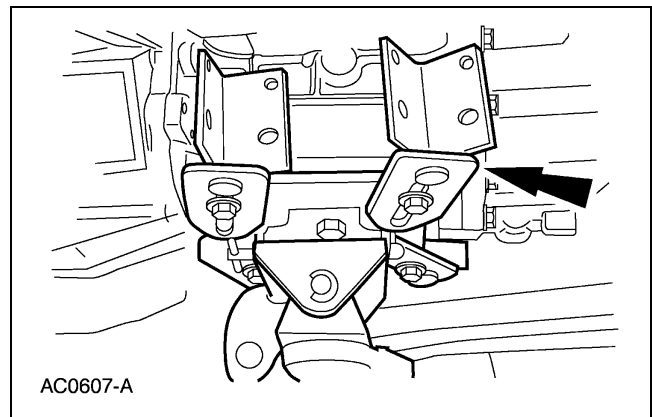

**REMOVAL (Continued)**

10. Remove the transmission crossmember.

- 1 Remove the crossmember-to-transmission bolt.
  - To install, tighten to 70 Nm (52 lb-ft).
- 2 Remove the 4 crossmember-to-frame bolts.
  - To install, tighten to 62 Nm (46 lb-ft).

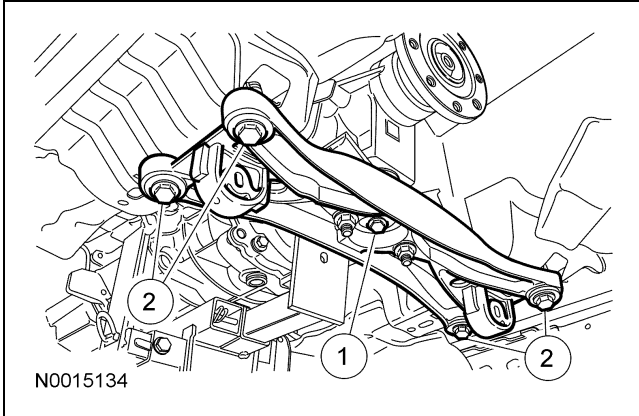

11. Lower the transmission 25.4 mm (1 in). Disconnect the shift linkage from the transmission.

- To install, tighten to 40 Nm (30 lb-ft).

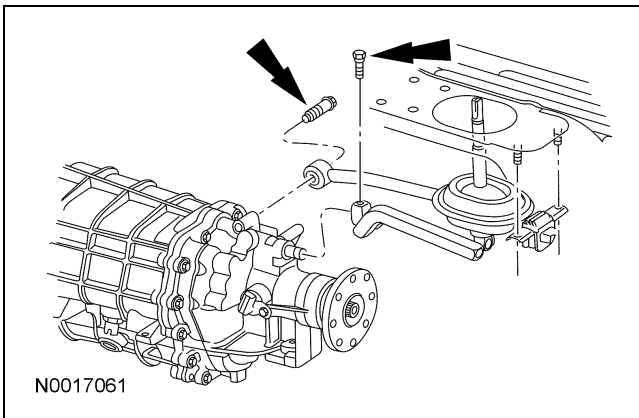

12. Release the clutch hydraulic line clip and separate the connector from the clutch slave cylinder.

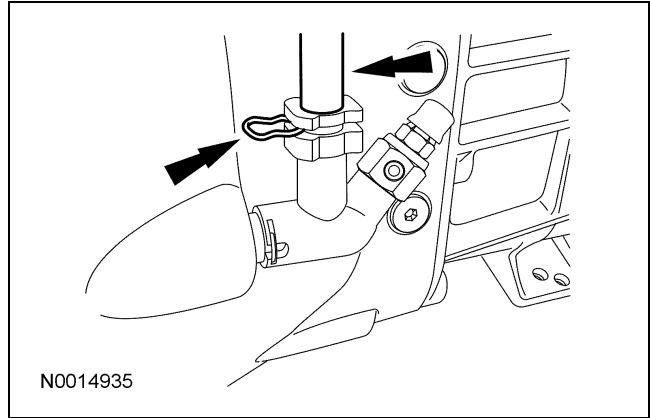

13. Remove the 8 transmission-to-engine bolts.

- To install, tighten 45 Nm (33 lb-ft).

14. Pull the transmission rearward until the input shaft is clear of the pressure plate, then lower the transmission from the vehicle.